

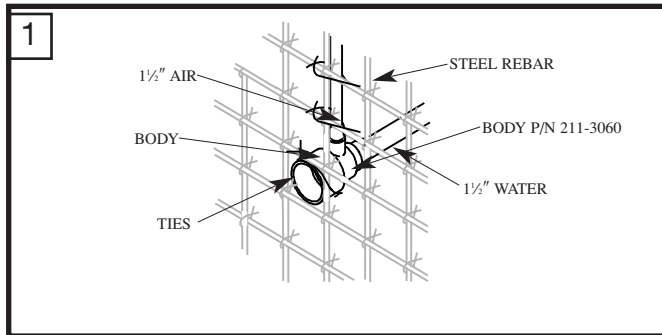

INSTALLATION INSTRUCTIONS

2½" STRAIGHT BODY POLY STORM GUNITE JET (P/N 210-3840)

INSTALLATION PROCEDURES AND PRESSURE TESTING



Hang Poly Storm Gunite Jet body with ties through preset holes onto steel rebar.

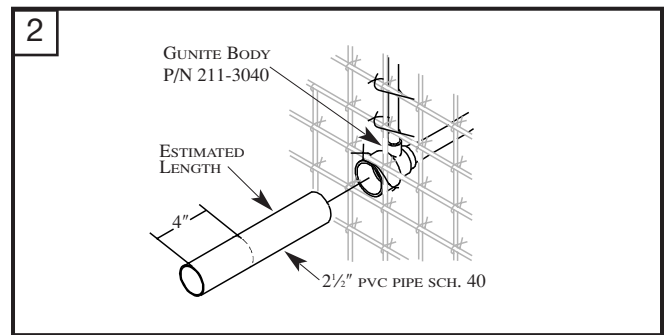

Estimate needed length of 2½" pvc pipe by thickness of wall. Cut 2½" pvc pipe at least 4" longer than estimated finish length. Then glue 2½" pvc pipe into body.

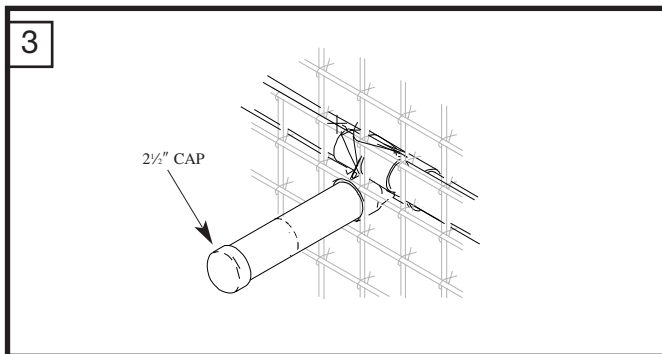

Glue 2½" cap onto the end of the pipe for pressure test before guniting..

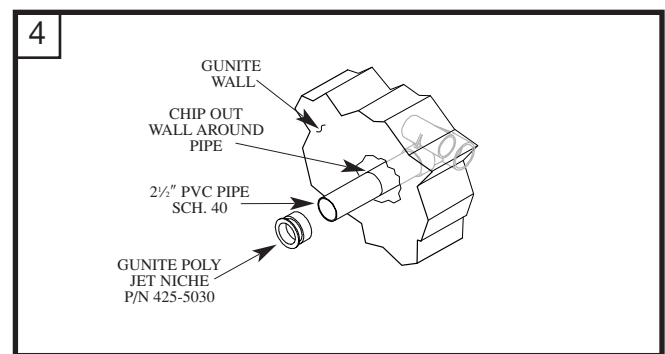

While gunniting, scoop out gunite around the 2½" pvc pipe allowing for the plaster niche P/N 425-5030 (Not Included). Before plastering, cut the 2½" pipe so that the plaster niche will fit flush with the finished wall. Glue the plaster niche onto the pipe, then cover the niche with tape for the plastering.

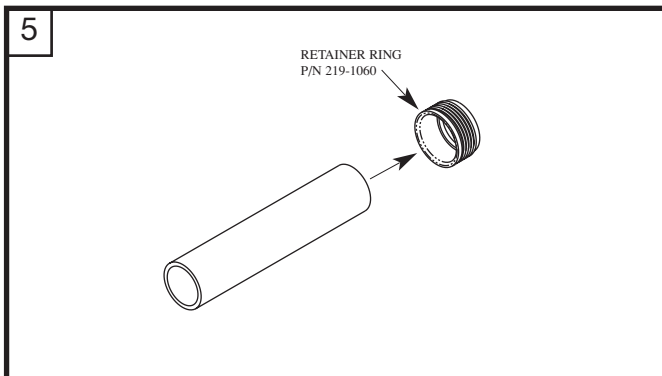

Cut a piece of 1" pvc pipe a couple of inches longer than the 2½" pipe and glue the threaded retainer ring to it.

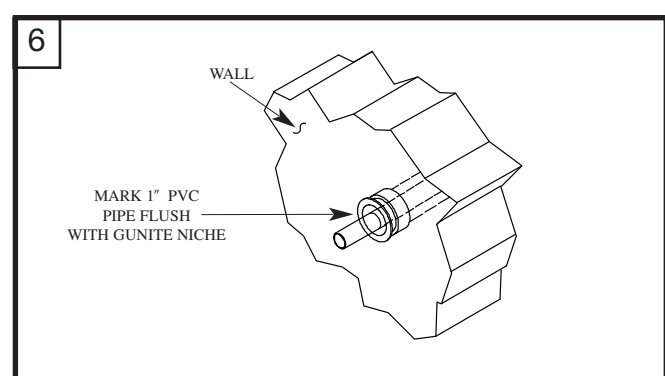

Insert 1" pvc pipe through the niche and up to the Poly Storm Gunite Jet body and thread in until it bottoms out. Make a mark on the 1" pvc pipe flush with the gunite niche.

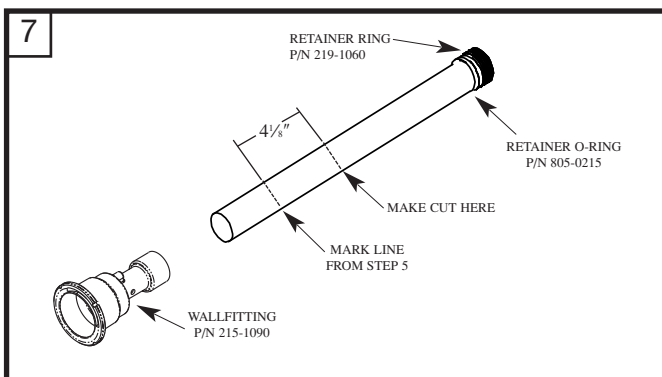

Unscrew 1" pvc pipe from body and cut 4⅞" inward from a mark towards retainer ring, then glue wallfitting to 1" pvc pipe.

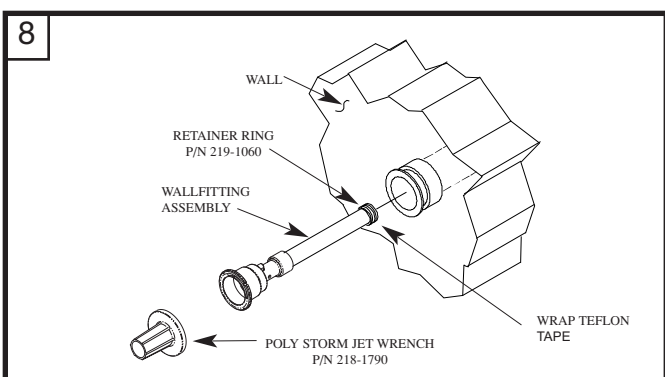

Wrap telfont tape onto the threaded retainer ring and thread the 1" pvc pipe back into the body using a Poly Storm Gunite Wrench (P/N 218-1790) making sure of a snug fit.



INSTALLATION INSTRUCTIONS **2½" STRAIGHT BODY POLY STORM GUNITE JET** **(P/N 210-3840)**

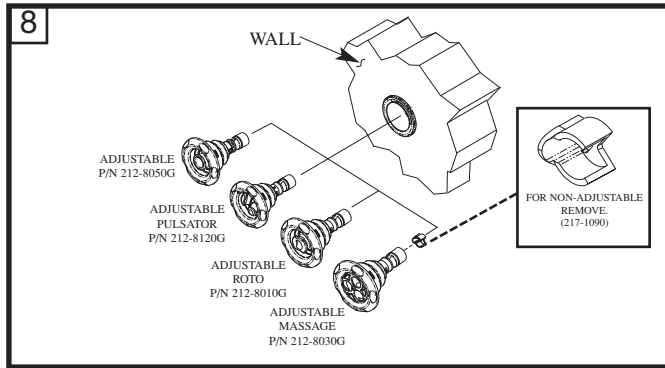

Always use at least one non-adjustable internal per spa to prevent deadheading pump.

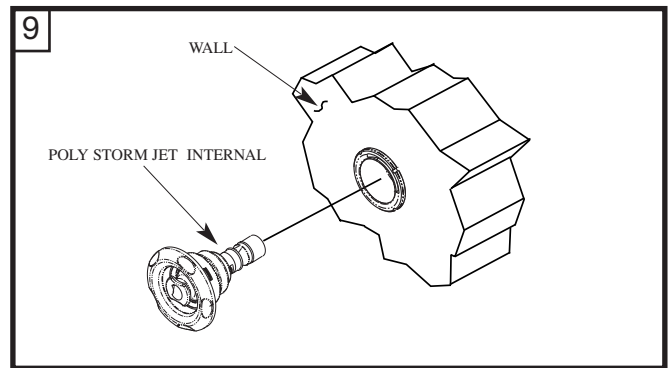

Align tab behind escutcheon face with slot on wall fitting. Location of slot and tab are shown below. Push poly internal into wall fitting until it snaps into place. To adjust water flow turn clock-wise to reduce water flow. To increase water flow turn counter-clockwise until it stops turning. To remove continue turning counter-clock wise past stopping point, you will hear a snap to confirm release of poly internal.

Tab behind poly escutcheon face



2½" schedule 40 PVC Pipe (Not Supplied)

NICHE (Not Supplied) P/N 425-5030

1" Schedule 40 PVC PIPE (NOT SUPPLIED)

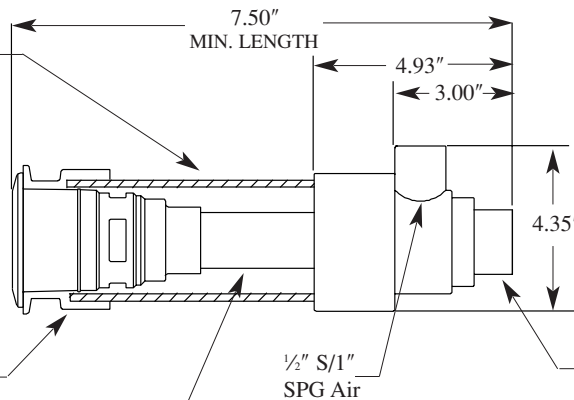

½" S/1" SPG Air

1" S/ 1½" SPG Water

POLY STORM JET INTERNALS & ACCESSORIES

Always use at least one Non-Adjustable internal per spa to prevent deadheading pump.

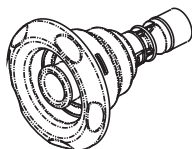

LARGE VOLUME INTERNAL
P/N 212-8047G
WHITE
12 GPM

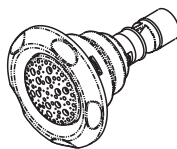

GALAXY INTERNAL
P/N 212-8190G
WHITE
10 GPM

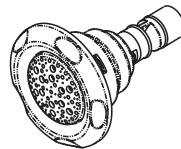

GALAXY MASSAGE INTERNAL
P/N 212-8530G
WHITE
10 GPM

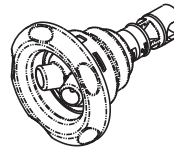

POWER STORM II INTERNAL
P/N 212-8250G
WHITE
10 GPM

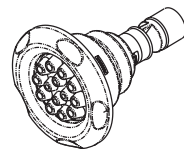

MULTI MASSAGE INTERNAL
P/N 212-8270G
WHITE
10 GPM

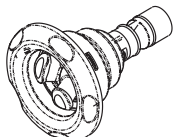

TWIN ROTO INTERNAL
P/N 212-8120G
10 GPM

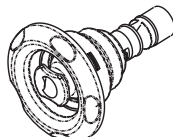

ROTO INTERNAL
P/N 212-8010G
WHITE
10 GPM

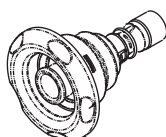

DIRECTIONAL INTERNAL
P/N 212-8050G
WHITE
10 GPM

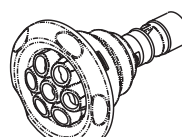

MASSAGE INTERNAL (7 NOZZLE)
P/N 212-8030G WHITE
10 GPM



WRENCH
P/N 218-1790



HANDHELD JET
P/N 210-3250
10 GPM